

AHD-SLP **Search Light Operation Panel**



Operates all search light functions

Up to 4 panels linkable

Integrated look and feel with other Boeing yacht products

Introduction

Search lights are intended to light waterways and shores. Additionally, they simplify manoeuvres in or close to the harbour at night and support search and rescue.

The proven design of Böning yacht products also applies to the search light operation panel AHD-SLP. The uniform design of operation panels creates a harmonic appearance of the console on the bridge or flybridge.

Operation

By pressing the 'Search light' button the search light is constantly switched on or off. When it is switched off, the 'Signal' button activates the search light as long as the button is pressed. The direction and elevation of the search light is controlled by four direction buttons with slow or fast speed. The speed is selected by pressing the 'Speed' button. When two opposite direction buttons are pressed simultaneously, the movement is stopped. By means of pressing e.g. 'up' and 'right' at the same time, the search light can additionally be panned diagonally. The 'Speed' LEDs indicate the speed for both horizontal and vertical search light movement.

- The LED is illuminated constantly when the search light is switched on.
- When the search light is switched off and any arrow button or the 'Speed' button is pressed, the LED flashes. After releasing the buttons the LED continues flashing for approx. 5 seconds.
- When a signal is generated, the LED is illuminated as long as the button is pressed.

Technical characteristics

The operation panel AHD-SLP is used for controlling the search light (e.g. type Sanshin HR1012-24 V). The basic functionalities are search light adjustment and switching the lamps on and off. The search light can conveniently be controlled from different places onboard (e.g. bridge and flybridge) due to the ability to link up a maximum of four AHD-SLP panels. The operation panel features backlit pushbuttons to control the search light.

The operation panel and search light are supplied with 24 VDC. The lamp and motors for vertical and horizontal adjustment are fed by a single power source. The device is protected against damage by incorrect wiring. The panel has to be protected by a 10 A fuse.

The search light lamps are supplied with 24 VDC, while the DC motors for horizontal and vertical movement are supplied with a maximum of 12 VDC. If the maximum output current of 1 A to 1.5 A is exceeded by the DC motors, the outputs are interrupted. This might occur if the motors are damaged or search light rotation is impeded. The error detection capabilities of the control outputs prevent the operation panel as well as the search light from damage due to overload.

The panel is intended for flush-mounting and is equipped with a plug-in 12-pin terminal block for connection of:

- Power supply (2 wires)
 - Additional panels for networking (4 wires)
 - Search light with built-in motors (6 wires)
-

Connection diagram for 1 operation panel

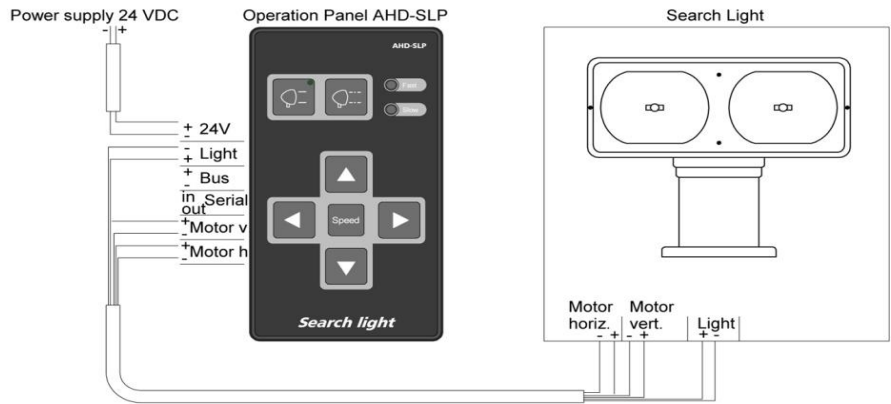

N.B.

Do not remove gaskets when disassembling the search light!

Connection diagram for 2 up to 4 operation panels

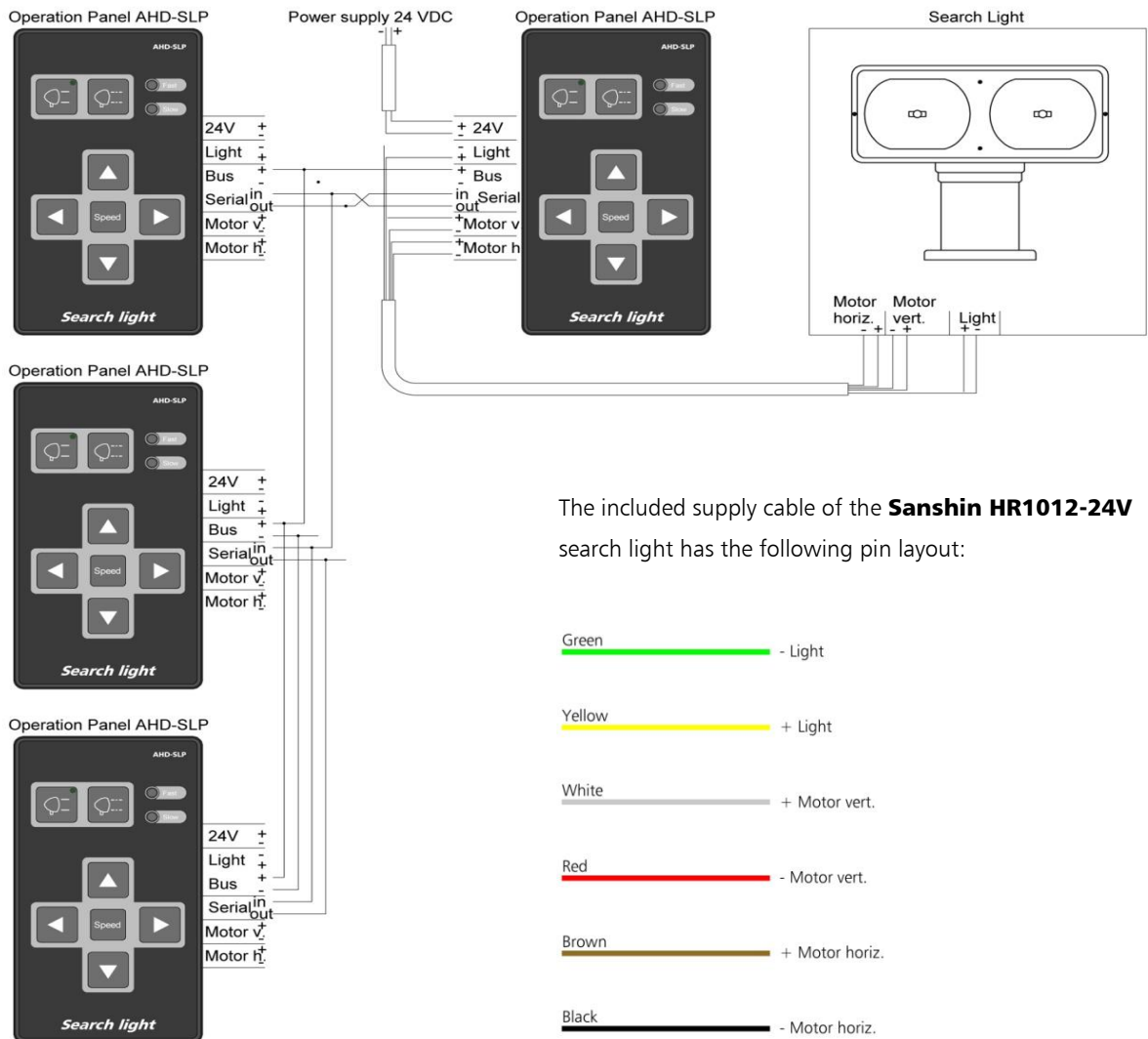

Dimensions, operating buttons, technical data

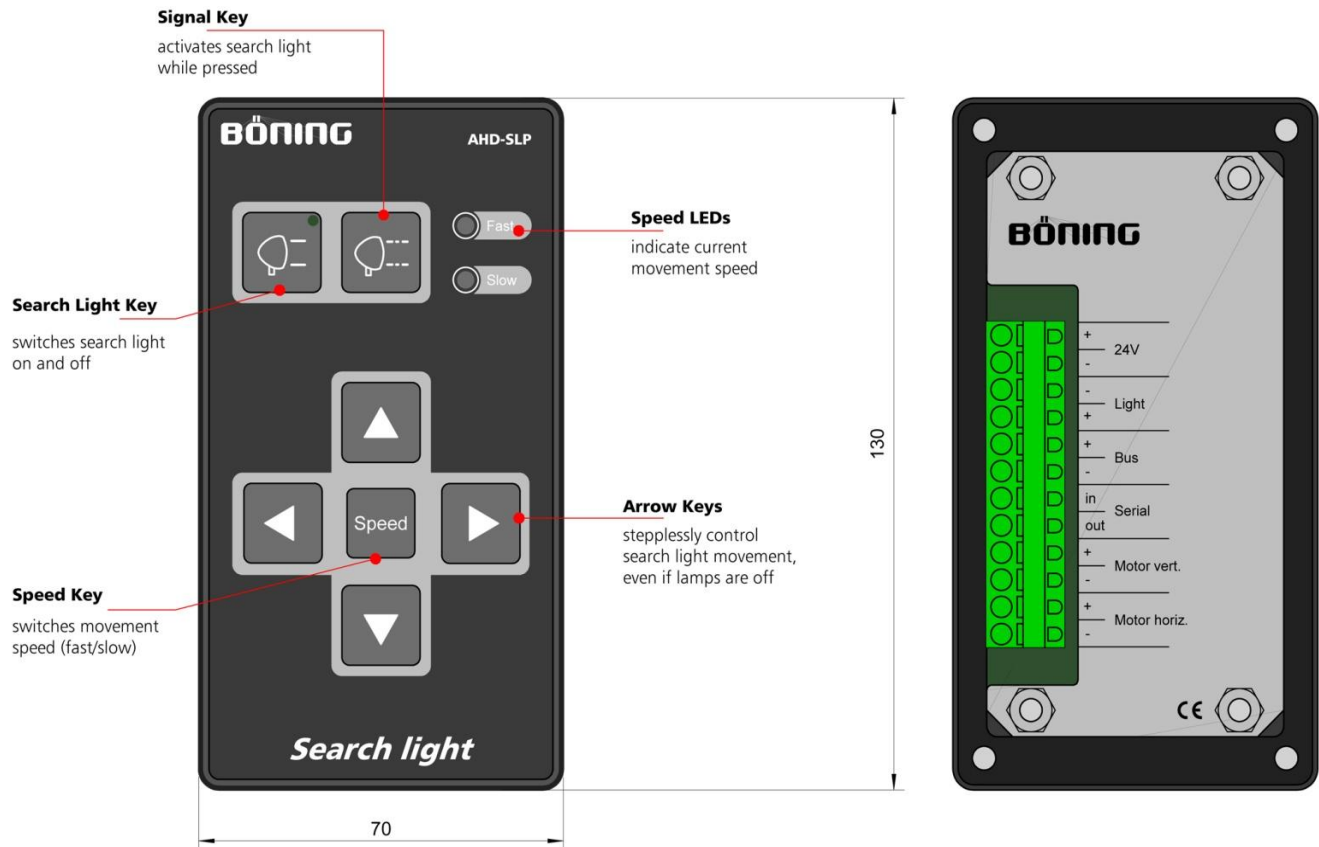

Pushbutton illumination

All pushbuttons are illuminated when power supply is connected.

AHD-SLP Search Light Operation Panel

| | |
|---------------------|-------------------------|
| Power supply | 24 VDC |
| Quiescent current | 30mA |
| Ambient temperature | -10 °C...70 °C |
| Storage temperature | -30 °C...85 °C |
| Weight | approx. 0.15 kg |
| Protection class | front IP 67, rear IP 20 |
| Dimensions | 70 mm x 130 mm x 66 mm |

Sanshin HR1012-24V search light

| | |
|-------------------|--------------------------|
| Power supply | 24 VDC |
| Power consumption | 5 A |
| Weight | ca. 3.25 kg |
| Protection class | IP 56 |
| Dimensions | 230 mm x 200 mm x 210 mm |