

# AHD-AP N2K

## NMEA2000 Engine Data Converter

- Captures MAN engine data without additional converter incl. alarm messages for main alarms, warnings, sensor faults and NMEA alerts
- Supports MAN EDC, CR and VNew engines
- Provides all data for visualization on NMEA2000 compatible plotters
- Alarm notification even in case plotters are powered off
- Galvanically separated from NMEA2000 system
- Automatic dimming of panel brightness
- Waterproof and UV resistant

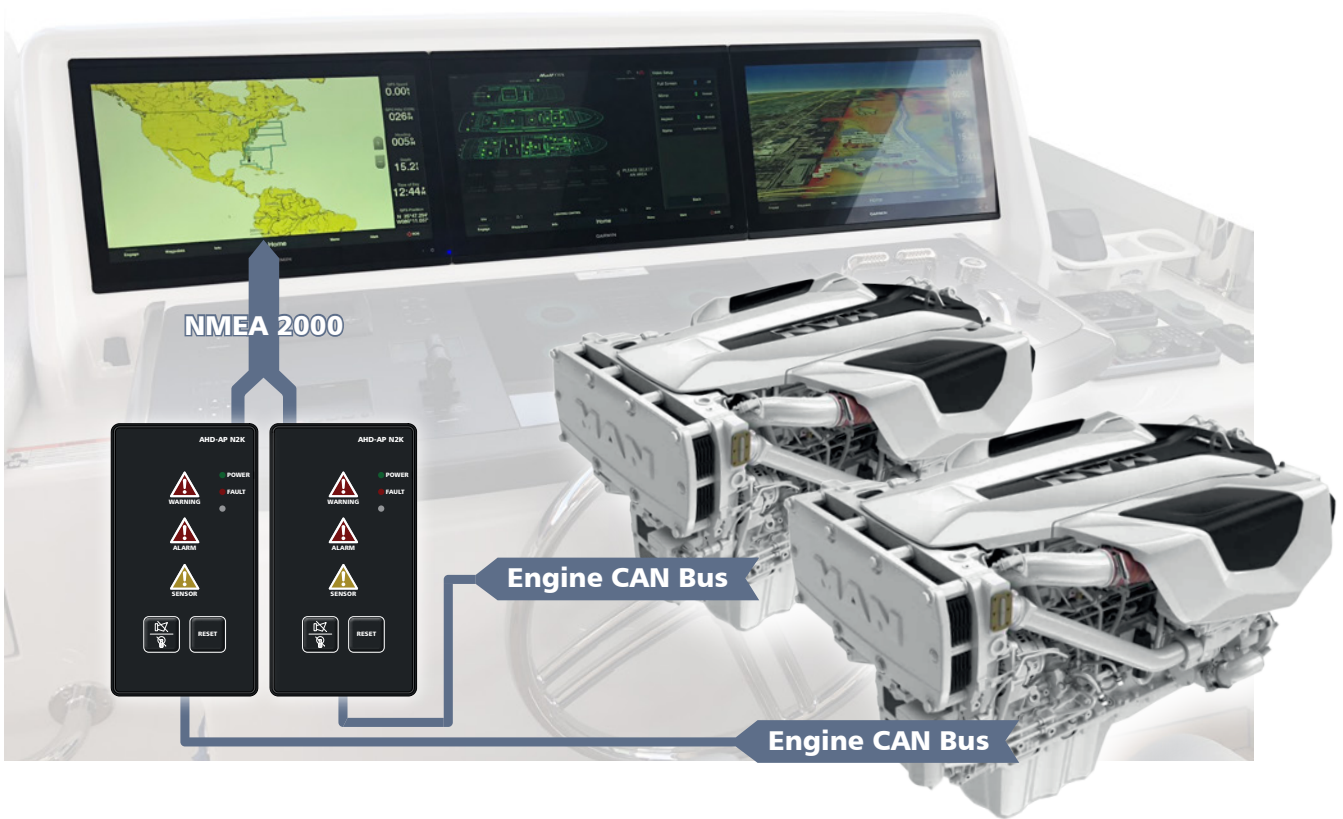

Values



Alarms



Alarm History

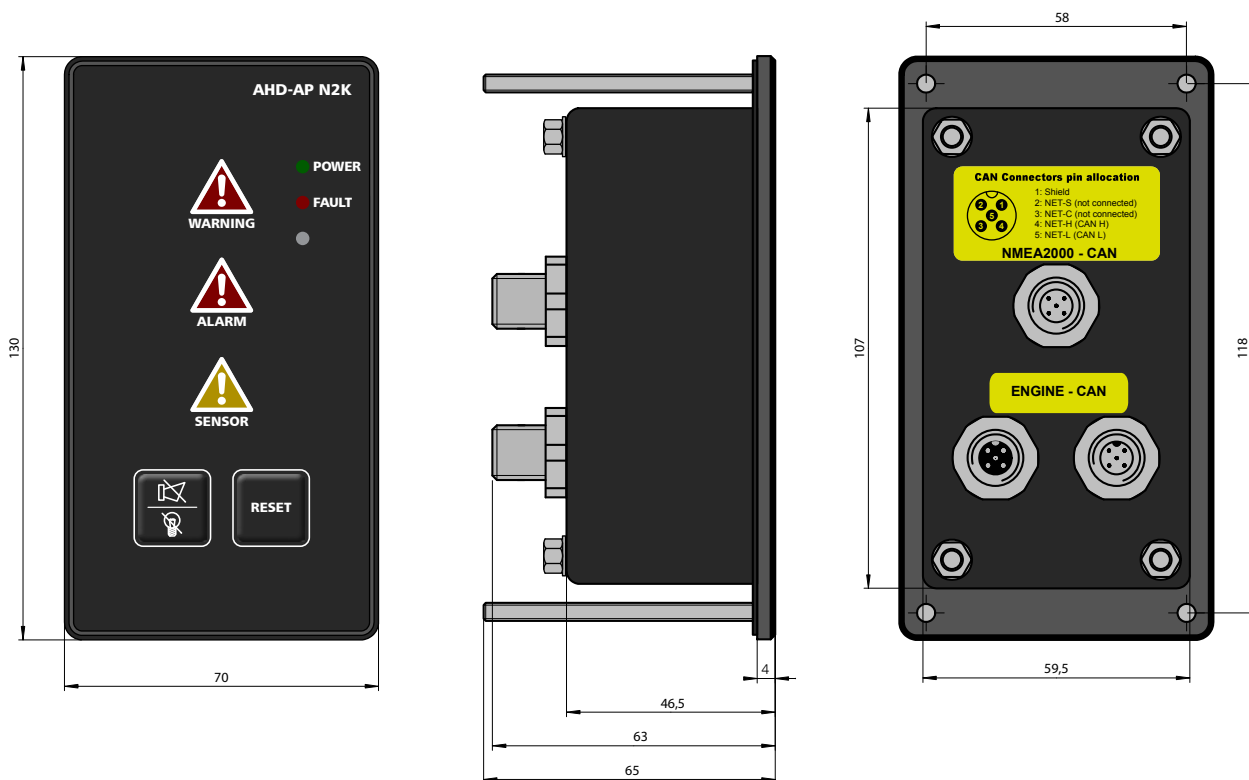

## Specifications

Dimensions	70(w) x 130(h) x 65(d) mm, installation depth with connectors 90mm
Panel Cutout	60 x 109mm
Weight	Approx. 0.3kg
Operating Temperature	-25°C ~ 70°C
Storage Temperature	-50°C ~ 85°C
Protection Class	IP 66 (front), IP 54 (back)
Power Supply	9 to 32 VDC (via engine CAN)
Power Consumption	approx. 70mA (ext. power supply)
Interfaces	Engine Bus 1x CAN, NMEA2000 Bus 1x CAN (CAN Bus is galvanically isolated, without termination resistor)



NMEA 2000® is a registered trademark of the National Marine Electronics Association  
 Böning Automationstechnologie GmbH & Co. KG  
 is manufacturer member of the National Marine Electronics Association

### Böning Automationstechnologie GmbH & Co. KG

Am Steenöver 4  
 27777 Ganderkesee  
 Germany

Phone: +49 4221 9475-0  
 Fax: +49 4221 9475-222  
 Email: info@boening.com



Texts and illustrations non-binding. Changes may be made due to technical improvements without further notice.